



1x | ASSY M37 R or ASSY I37R RF (IR)



2x | insulation ring



2x | filter



2x | connector RJ45
only for model: ASSY I37R RF (IR)



1x | BNC installation set
only for model: ASSY M37

Warning

This equipment should be installed, operated, serviced, and repaired by qualified personnel only. The installation and interconnection of this equipment to facility wiring and other equipment must be done by a competent, qualified craftsman who is familiar with applicable standards and codes governing the installation. Installation methods, practices, or procedures that are unauthorised or done improperly are dangerous and could result in serious personal injury or damage to property and equipment.

dimensions

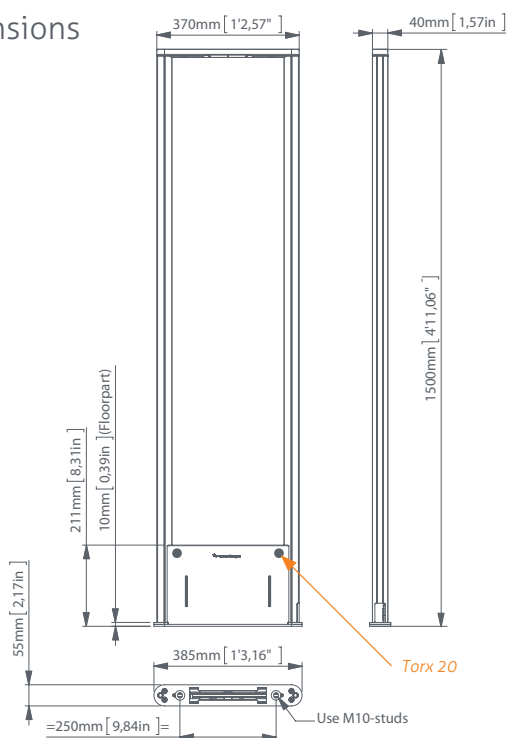

conduit or slit

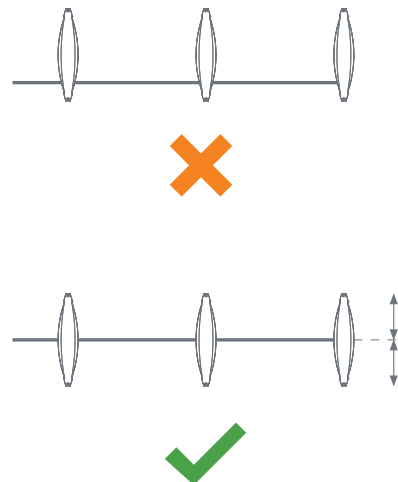

drill the hole

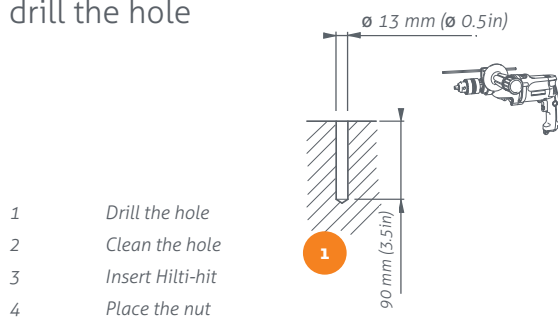

- 1 Drill the hole
- 2 Clean the hole
- 3 Insert Hilti-hit
- 4 Place the nut

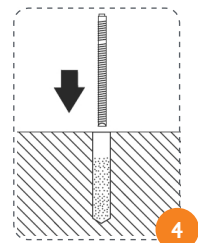
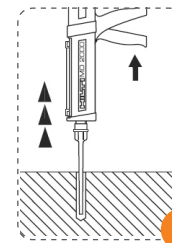
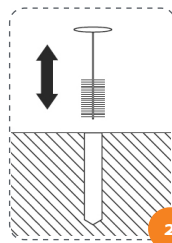

always use a nylon insulation ring

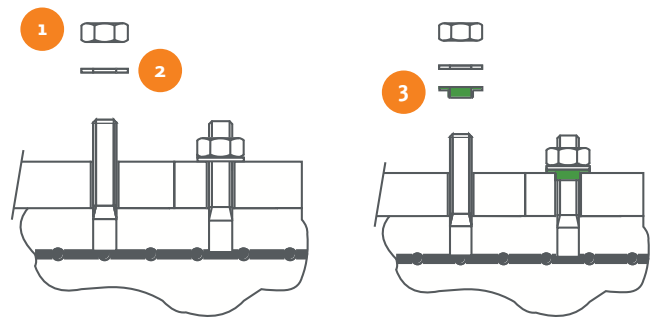

- | | | |
|---|---------------------------|------------------------------------|
| 1 | Nut M10 | (not included in installation set) |
| 2 | Retainer ring M10 | (not included in installation set) |
| 3 | Nylon insulation ring M10 | (included in installation set) |



internal electronic Renos



"model: ASSY I37R RF and model: ASSY I37R RF IR"

connect cables

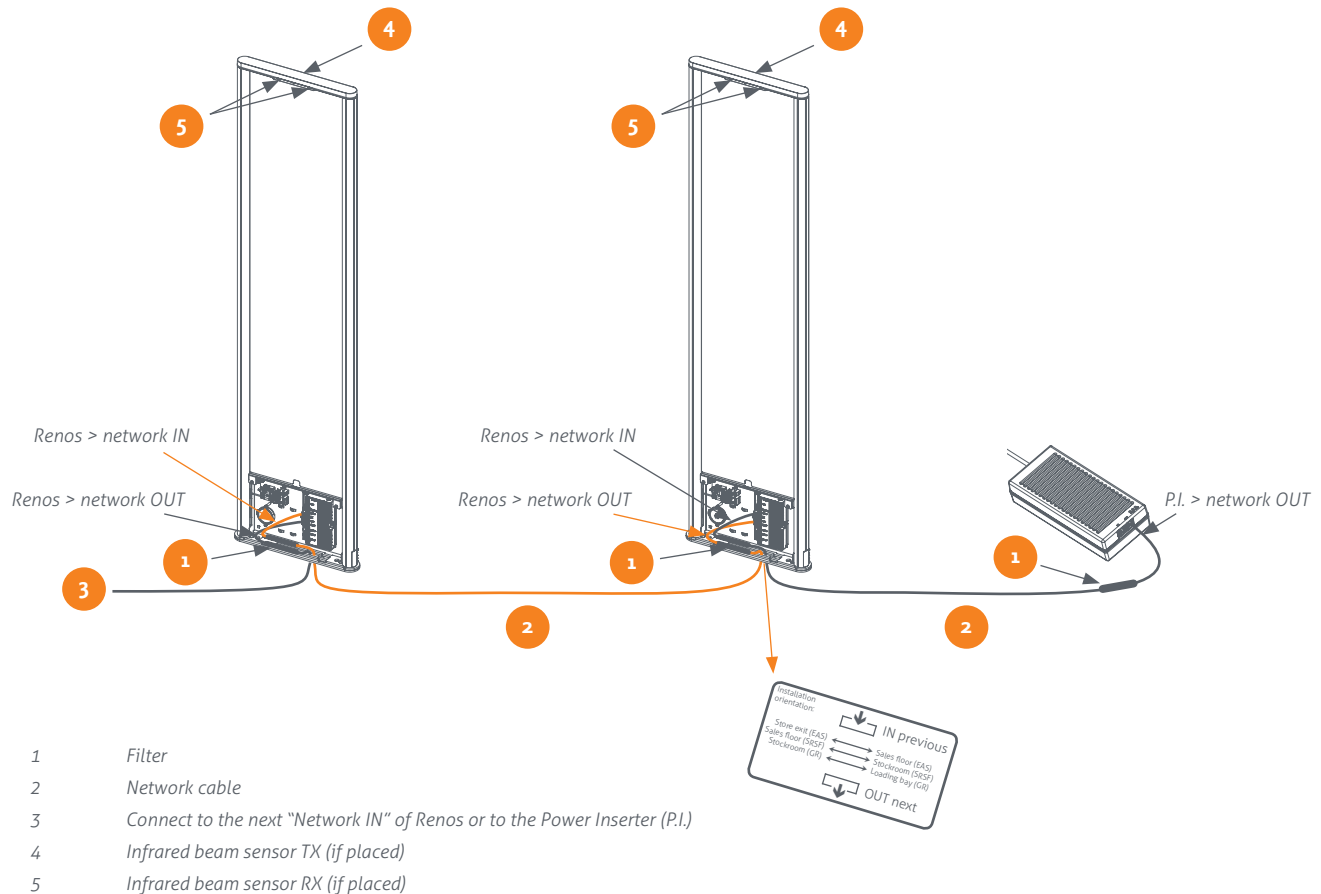

power system

Plug the Power Inserter into the socket.

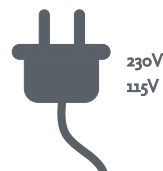

IMPORTANT:

Network should be connected in the "network setup"-step of the installation wizard. Do not connect a network to !Sense before power up!

NOTE:

Start up takes approximately 3 minutes.

connecting a laptop to the Renos unit

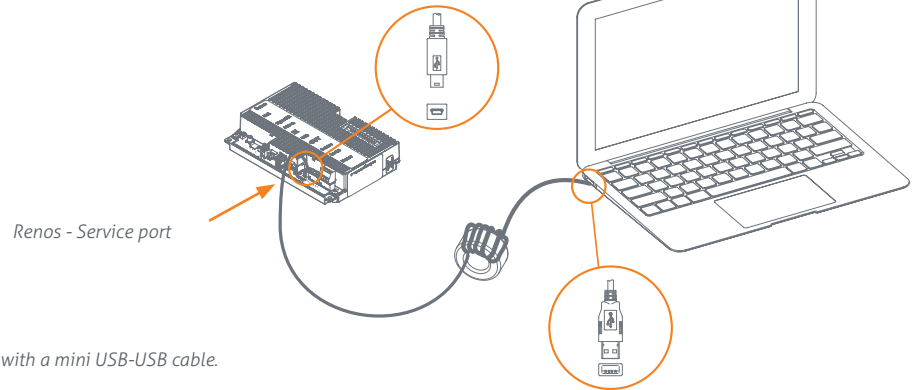

Attach your laptop to one of the Renos units with a mini USB-USB cable.
Open the browser on your laptop and go to:

<http://192.168.133.1>

Configure the system using the installation wizard.

external electronic Economy ↓ "model: ASSY M37 RF"

economy (OST)

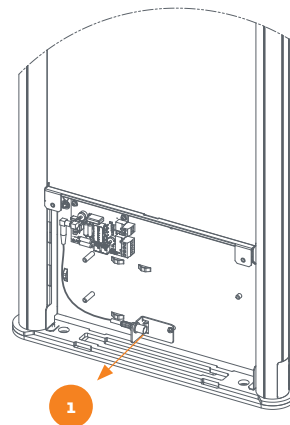

1 BNC connector

network setup

When on the "network setup" -step of the installation wizard,
determine the position of the network and decide how to connect to the !Sense network.

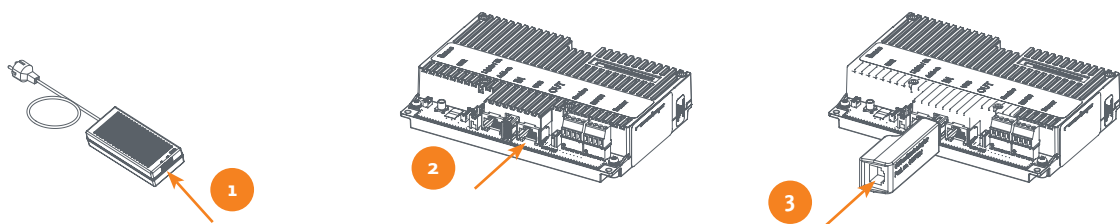

- 1 Network to Power Inserter IN
- 2 Network to last Renos OUT
- 3 Network to USB-Network adapter (in any gate)

Renos

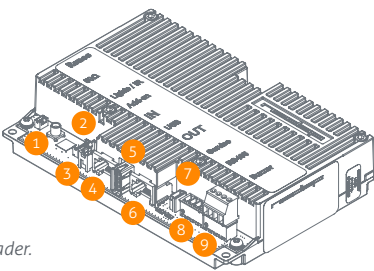

1	50Ω	Connect to the 50Ω PCB from the antenna.
2	Infrared beams	Connect to the lights.
3	Add-on	Provide power and synchronisation to add-ons, like the RFID reader.
4	Network IN	Connected to the Network OUT of a previous Renos unit or a Power Inserter.
5	USB	Connect accessories to Renos, like the RFID reader or USB network adapter.
6	Network OUT	Connected to the Network IN of a previous Renos unit or a Power Inserter. Can also be left unconnected or connected to the customer network.
7	Mini USB service port	Connect your laptop to configure the Renos system.
8	RS485 connector	Connect to the smart deactivator(s).
9	Buzzer connector	Connect to the buzzer.

Caution:

Risk of Explosion if Battery is replaced by an Incorrect Type. Dispose of Used Batteries According to the Instructions.

status LEDs Renos

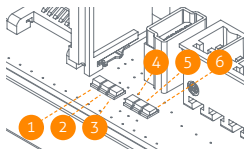

1	Green	On	There is a Renos unit connected to the OUT port of this unit
		Off	There is no Renos unit connected to the OUT port of this unit
2	Blue	Blinking	There is no device connected to the OUT port of this unit
		On	There is a Power Inserter connected to the OUT port of this unit
3	Red	On	There is an issue with the power supply at the OUT port of this unit (too little current drawn)
		Blinking	There is an issue with the power supply at the OUT port of this unit (too much current drawn)
		Off	There is no issue with the power supply at the OUT port of this unit
4	Yellow	Blinking	The operating system on the Renos unit is running
		Off	The operating system on the Renos unit is not running
5	Green	Blinking	The storage flash on the Renos unit is accessed
		Off	The storage flash on the Renos unit is not accessed
6	Green	On	The firmware on the Renos unit is running
		Off	The firmware on the Renos unit is not (yet) running

Disclaimer

Nedap intends to make this manual accurate and complete. However, Nedap does not warrant that the information contained herein covers all details, conditions or variations, nor does it provide for every possible contingency in connection with the installation or use of this product. Nedap disclaims any liability for damage to property or personal injury resulting, in whole or in part, from improper installation, modification, use or misuse of its products. The information contained in this document is subject to change without notice.

Declaration of Conformity

Hereby, De N.V. Nederlandsche Apparatenfabriek "Nedap" declares that the radio equipment type ASSY I37R RF, ASSY I37R RF IR, ASSY M37 RF is in compliance with Directive 2014/53/EU.

The full text of the EU declaration of conformity is available at the following internet address: <https://portal.nedapretail.com/>

User manual

The complete instruction manual can be found at <https://portal.nedapretail.com/>